

Body Type

MO-S5788-3D

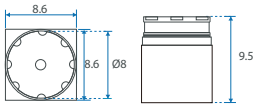

MO-S5788-2V

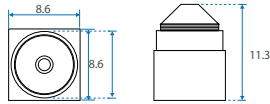

MO-S5788-3M
MO-S5588-3X6

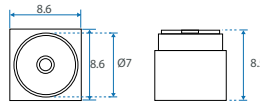

MO-S5788-3T

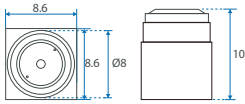

MO-S5788-2S

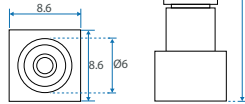

MO-S5788-3K

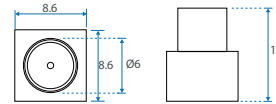

MO-S5788-2E

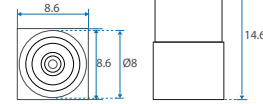

Specification

Unit : mm (± 0.5)

Model	MO-S5788
Pixel size	6 um x 6 um
Effective Image Area	3.8mm (H) x 2.9mm (V)X4.86mm(D)
Video system	EIA / CCIR
Number of effective pixels	648 x 488 (EIA & CCIR)
Image sensor	1/4" CCIQ III Color Camera
Resolution(TV Lines)	550 TV Lines
S/N Ratio	47 dB
Dynamic range	63.3 dB
Sensor scan mode	progressive scan
Minimum illumination	0.006LUX / F1.2
Image Transfer Rate	60 field/sec CVBS(EIA), 50 field/sec (CCIR)
Sensitivity	8.2 [V/Lux.sec]
Horizontal sync frequency	EIA - 15.734kHz, CCIR - 15.625kHz
Vertical sync frequency	EIA - 60Hz, CCIR - 50Hz
Camera consumption	0.45
Video output	1Vp-p, 75ohm composite
Storage temperature	-30 to 60 Degree C
Working temperature	-10 to 45 Degree C
Power source	DC 5~12V
Power current	100 mA(max)
Dimension (mm)	8.6 x 8.6 (mm)



▲ MO-S5788-3D



▲ MO-S5788-2S
MO-S5788-2ES



▲ MO-S5788-2V



▲ MO-S5788-3K



▲ MO-S5788-3T,
MO-S5788-4T



▲ MO-S5788-3M,
MO-S5788-3X6



▲ MO-S5788-2E

Ordering Information

MODEL	FOCUS LENS	MIC.	LENS THREAD
MO-S5788A-3D	3.9mm / F2.8	External	M7 mm, P0.5mm
MO-S5788A-2V	2.95mm / F3.2	External	M7 mm, P0.5mm
MO-S5788A-3T	3.1mm / F3.4	External	M7 mm, P0.5mm
MO-S5788A-4T	3.9mm / F3.9	External	M7 mm, P0.5mm
MO-S5788A-2S	2.1mm / F2.5	External	M5.5 mm, P0.35mm
MO-S5788A-3K	2.8mm / F3.9	External	M5.5 mm, P0.35mm
MO-S5788A-3X6	3.4mm / F6.0 High DOF	External	M6 , P0.35mm
MO-S5788A-3M	3.4mm / F2.8	External	M6 , P0.35mm
MO-S5788A-2E	2.3mm / F2.6	External	M7 mm, P0.5mm
MO-S5788A-2ES	2.3mm / F2.6	External	M5.5 mm, P0.35mm

NOTE:
MO-S5788A-3D ▲: external microphone